

REGIONE PUGLIA

PROGRAMMA INTEGRATO DI RIQUALIFICAZIONE DELLE PERIFERIE
"LA LOGGA DELLE PUGLIE"

COMUNE DI SANT'AGATA DI PUGLIA



PROGETTO ESECUTIVO

Opere di urbanizzazione primaria

2 VIABILITA' - ASCENSORE INCLINATO

carpenteria modulo di arrivo EG162.12

Scala 1 : 50

PROGETTISTI : R.F. Ingg.

Info DESCRIZIONE 2010

Mistralli R.F. - meridionale
Frescura G.B. - meridionale
Disanto G. - meridionale
Poddaio F. - meridionale

REGIONE

DATA

ESISTENTE

VERIFICATO

APPROVATO

REVISIONE

Comune

Cod. catastale

Indirizzo

N° Fogli

Foglio

Area Totale

Perimetro, mq/ha

R.F.P.

Ing. Mistralli - Frescura - Disanto - Poddaio

85100 - POTENZA - via Brancaccio, 36 - Tel./Fax 0971 419377 - email : rocconimistralli@libero.it

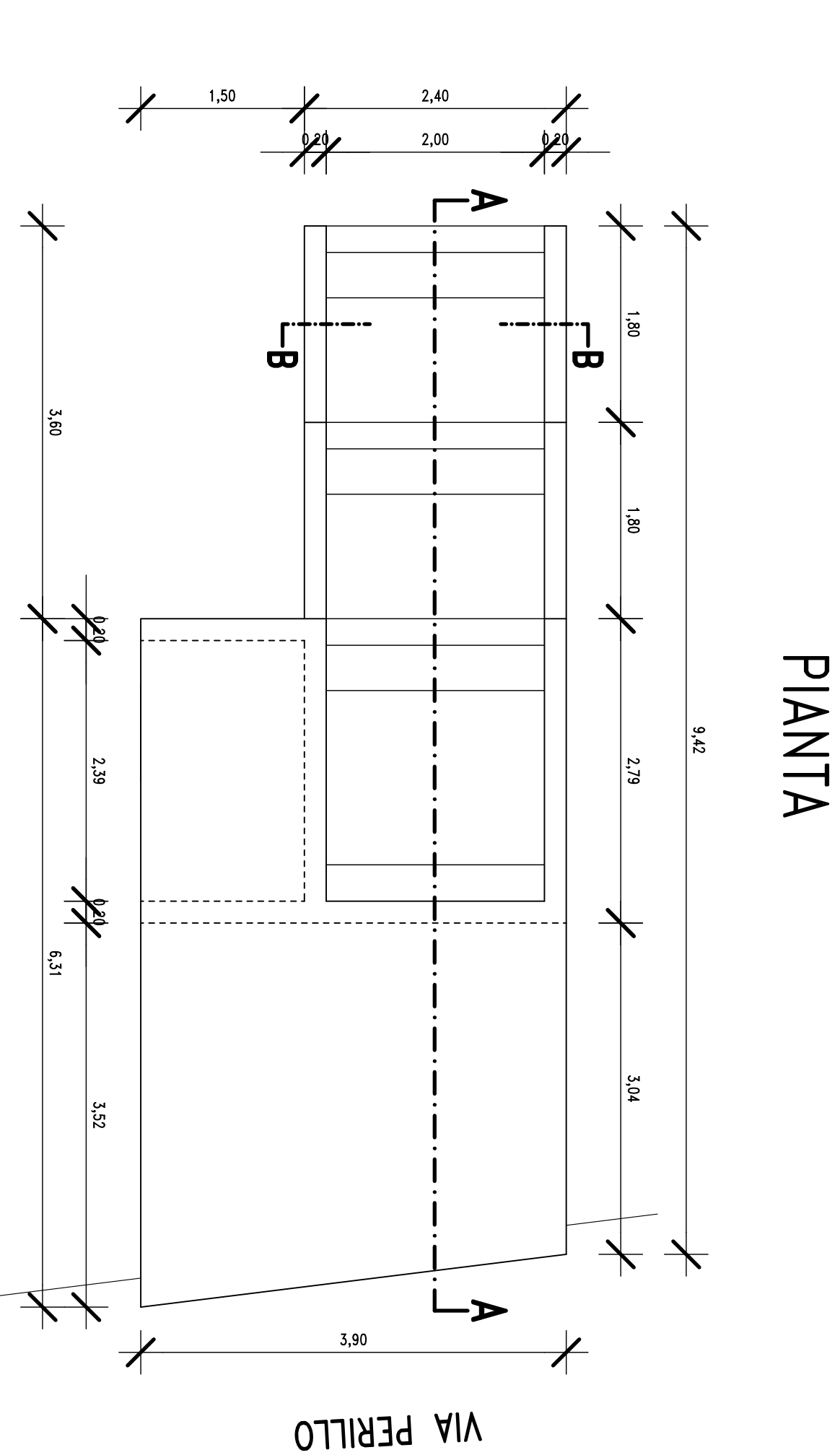

SEZIONE A-A

SEZIONE B-B

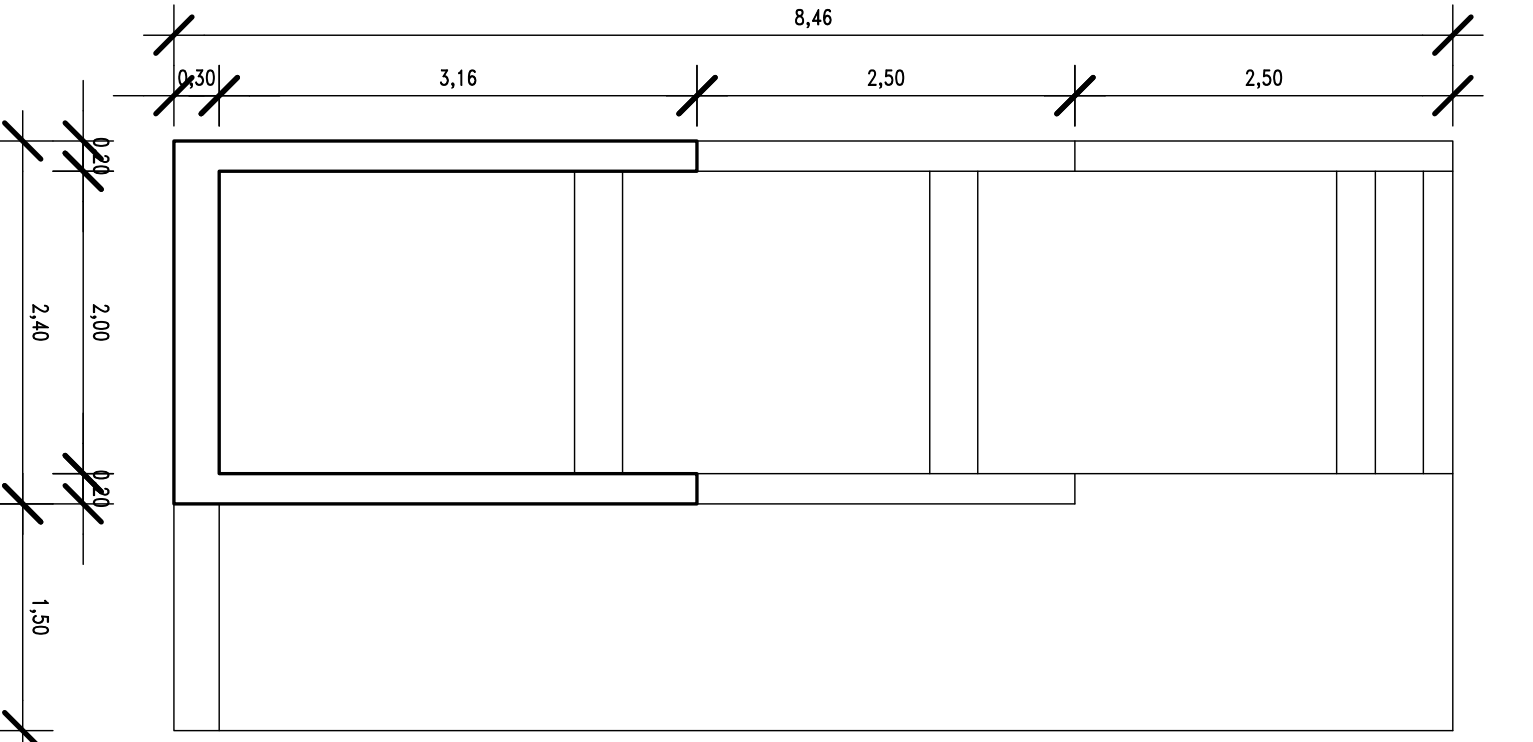
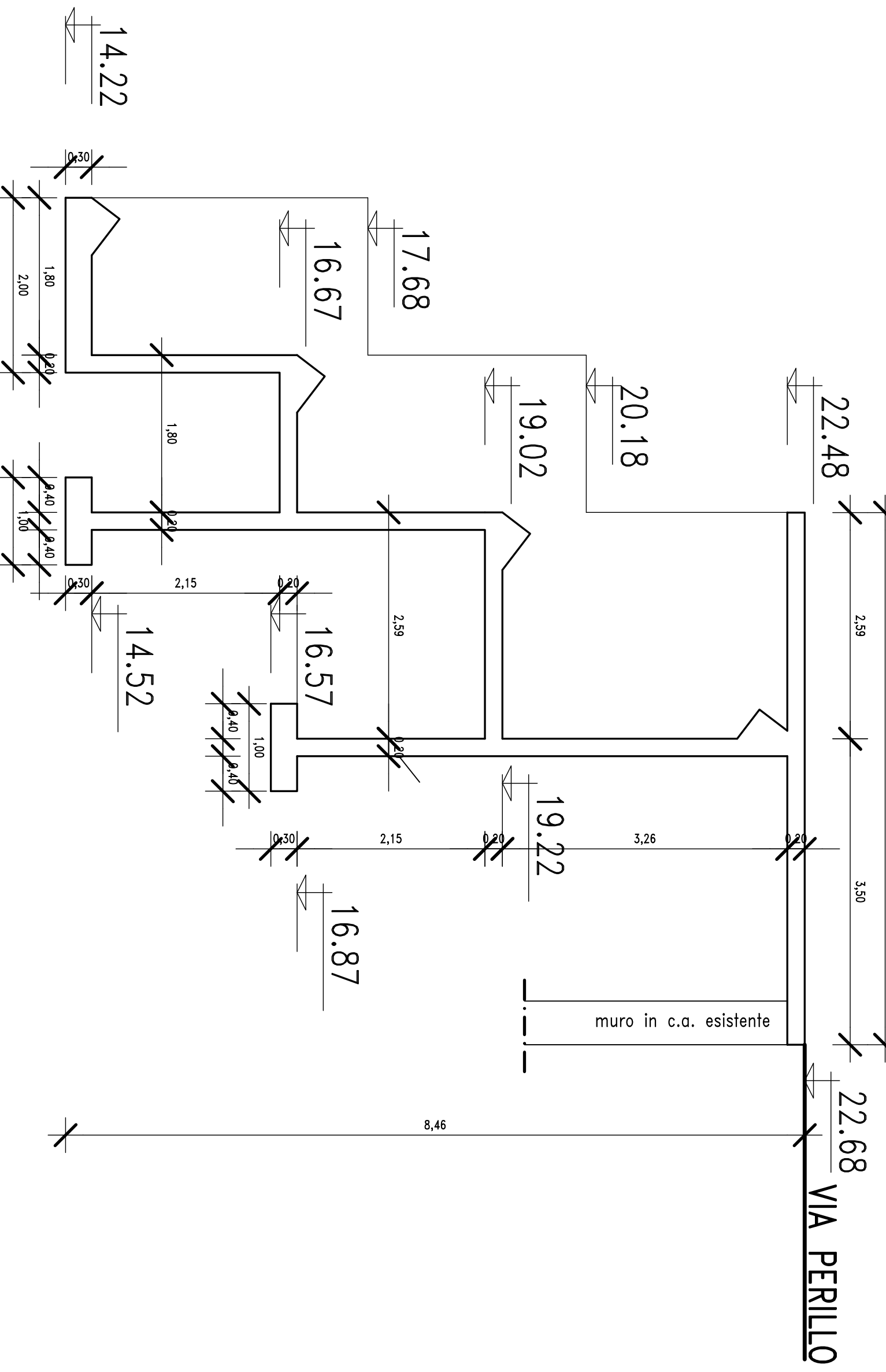

CARPENTERIA A QUOTA +14,22

PIANTA

SEZIONE C-C

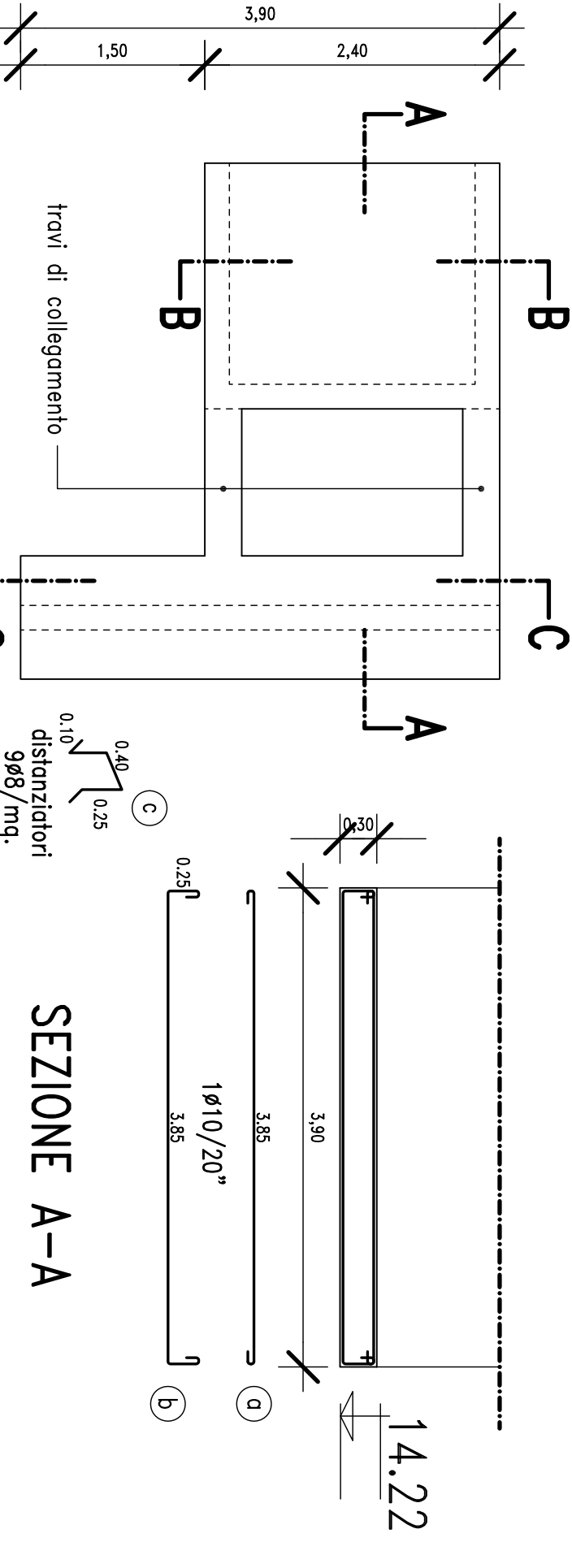

SEZIONE A-A

SEZIONE B-B

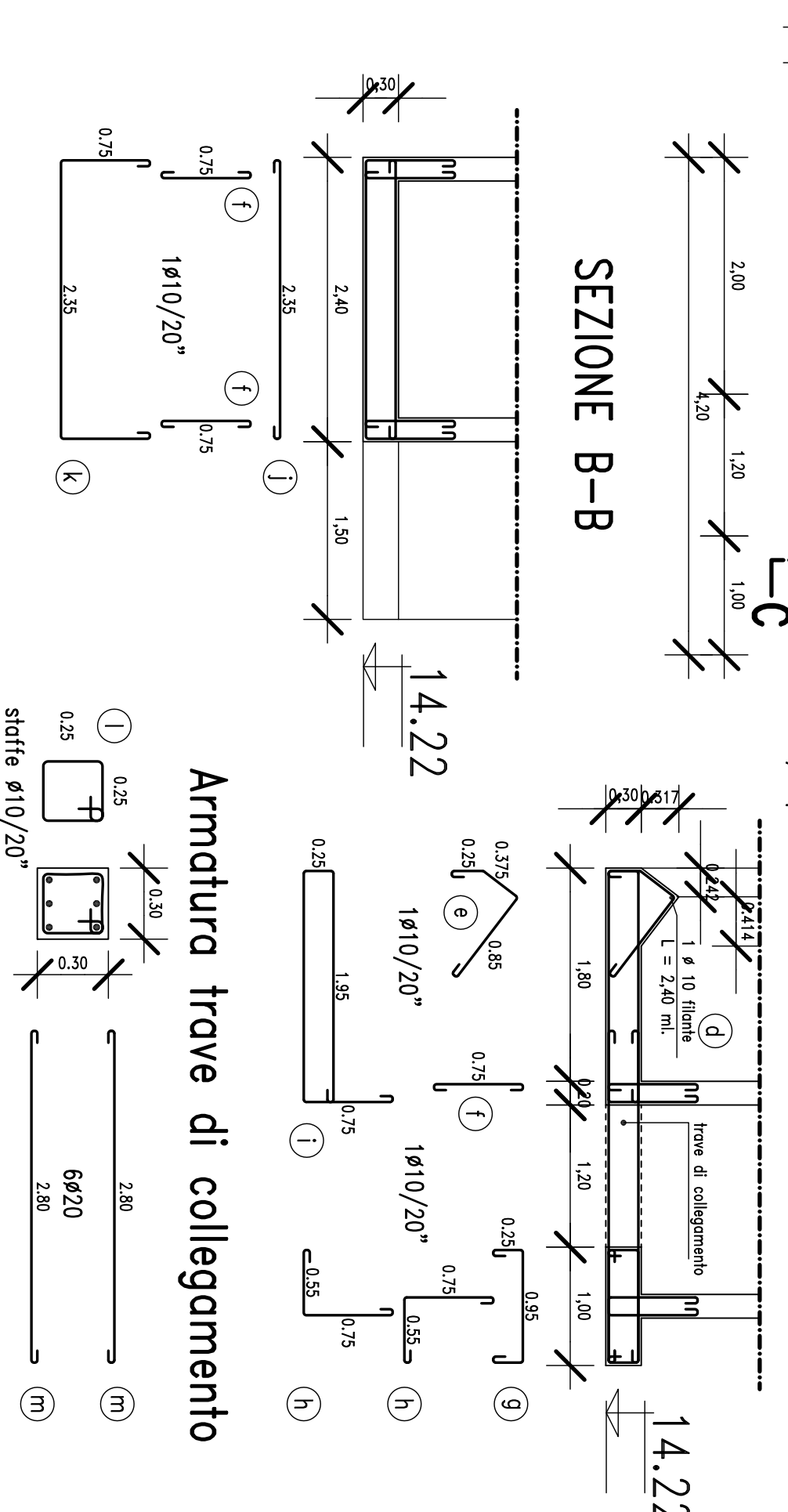

Armadura trave di collegamento

CARPENTERIA DA QUOTA +14,52 A QUOTA +16,67

ARMATURA ORIZZONTALE

SEZIONE B-B

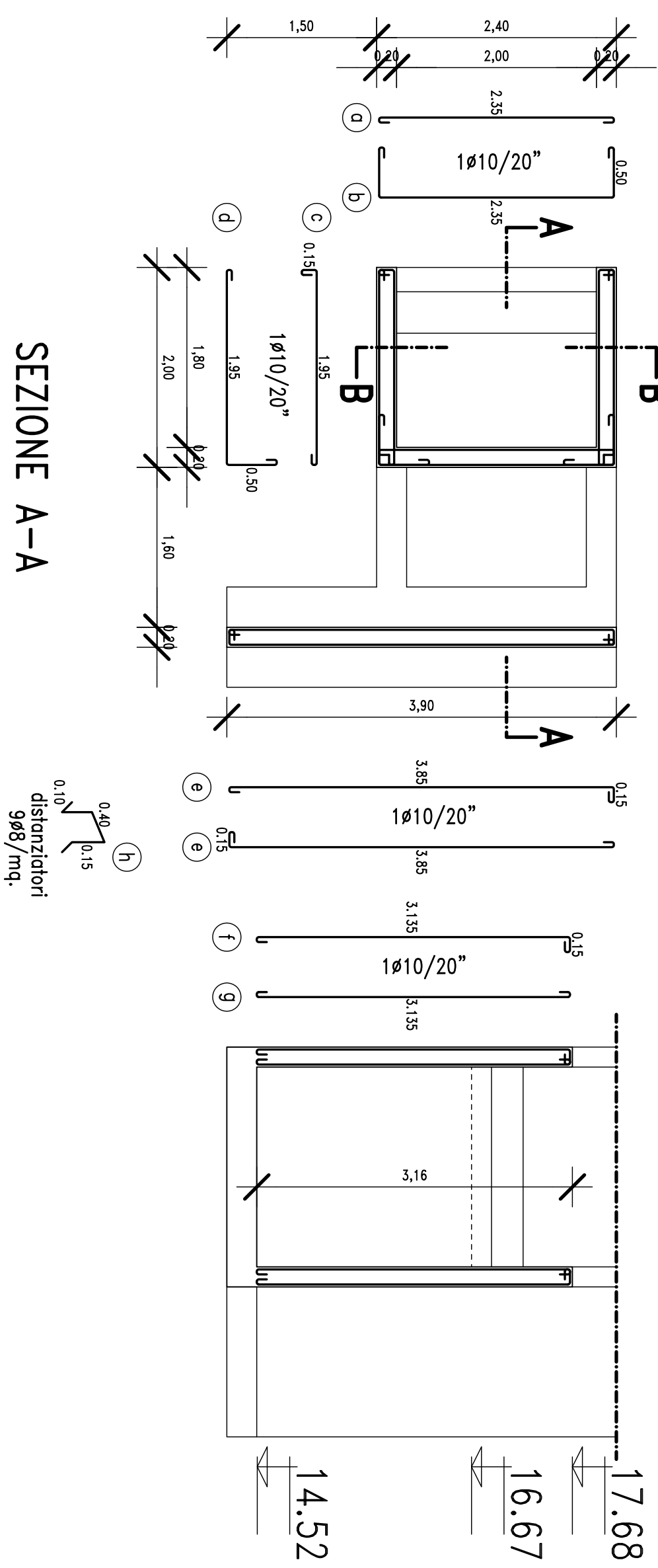

SEZIONE A-A

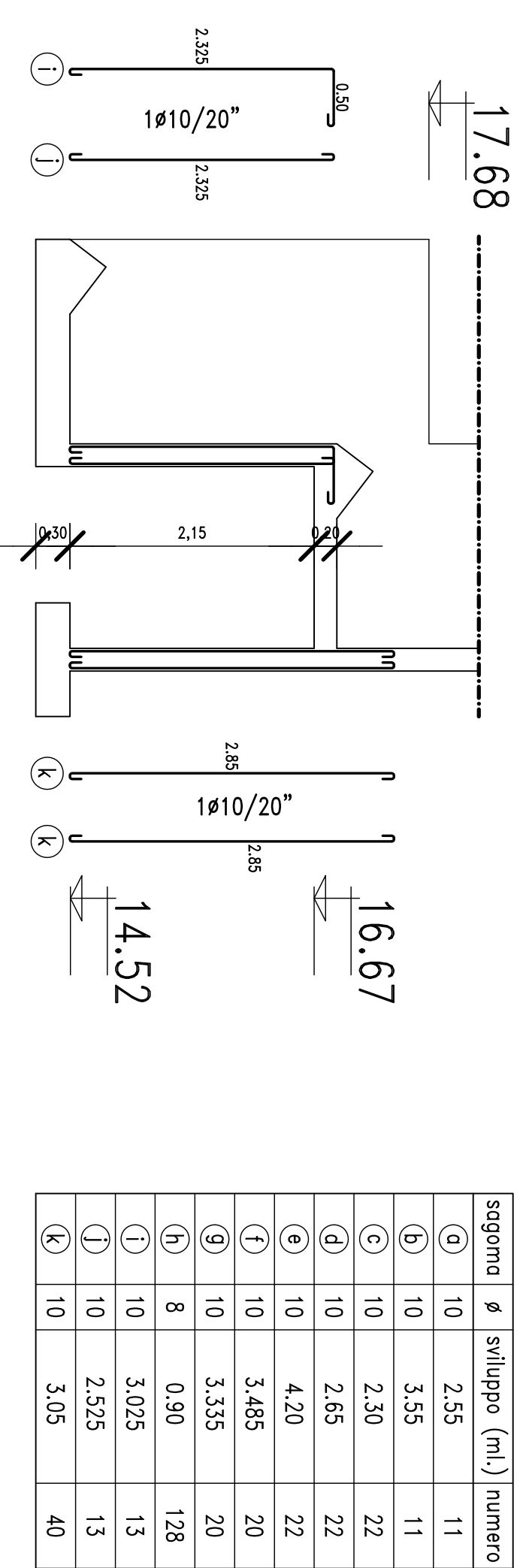

sezione	#	sviluppo (m.)	numero
Ⓐ	10	4.15	6
Ⓑ	10	4.45	6
Ⓒ	8	1.10	26
Ⓓ	10	2.60	11
Ⓔ	10	1.675	11
Ⓕ	10	0.95	31
Ⓖ	10	1.85	21
Ⓗ	10	1.30	42
Ⓘ	10	5.10	11
Ⓛ	10	2.55	10
Ⓚ	10	4.05	10
Ⓜ	20	3.00	12

CARPENTERIA A QUOTA +16,57 e +16,67

PIANTA

SEZIONE C-C

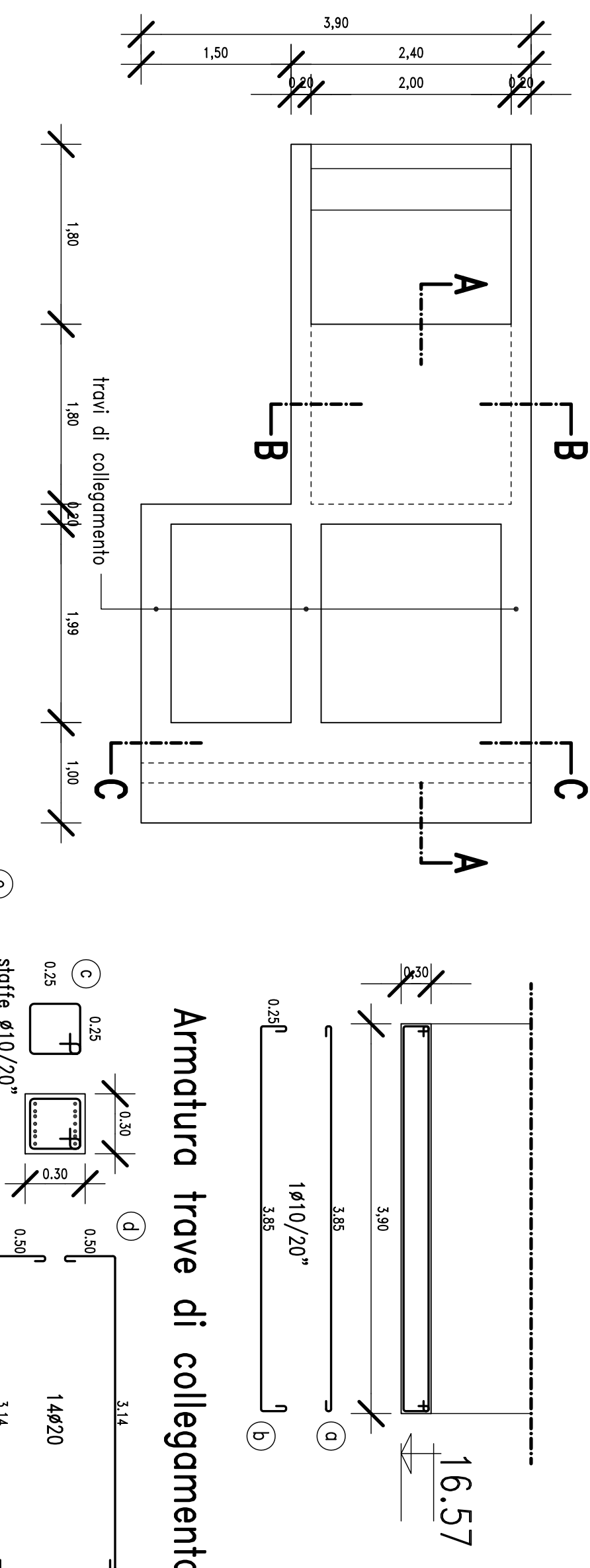

SEZIONE A-A

SEZIONE B-B

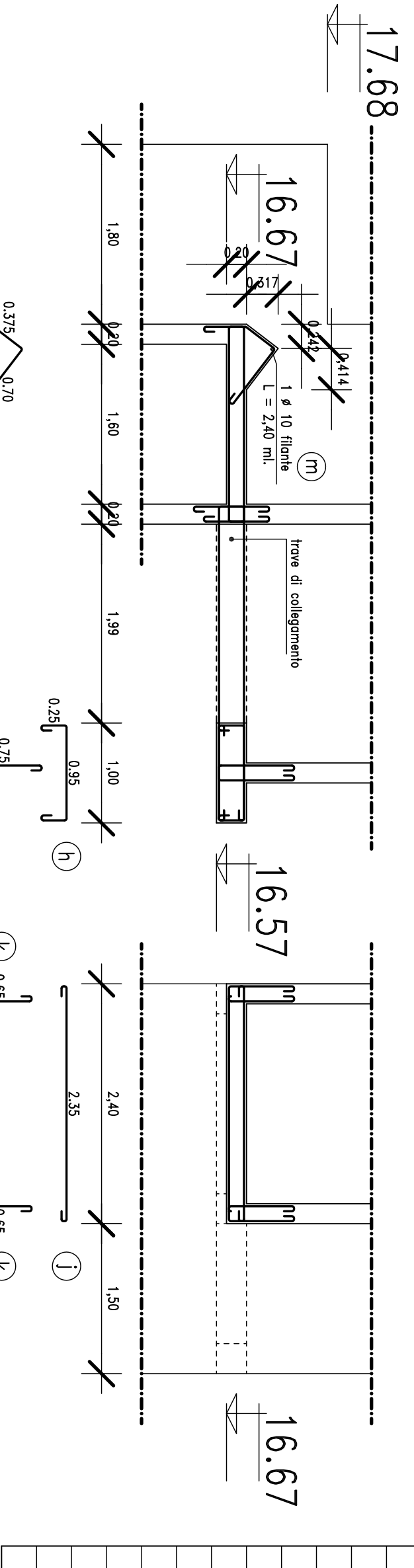

sezione	#	sviluppo (m.)	numero
Ⓐ	10	4.15	6
Ⓑ	10	4.45	6
Ⓒ	10	1.20	21
Ⓓ	20	3.84	42
Ⓔ	8	0.90	26
Ⓕ	10	1.675	11
Ⓖ	10	3.05	11
Ⓗ	10	1.85	21
Ⓘ	10	1.50	42
Ⓛ	10	2.55	10
Ⓚ	10	0.95	20
Ⓜ	10	4.05	1

CARPENTERIA DA QUOTA +16,67
A QUOTA +17,68

ARMATURA ORIZZONTALE

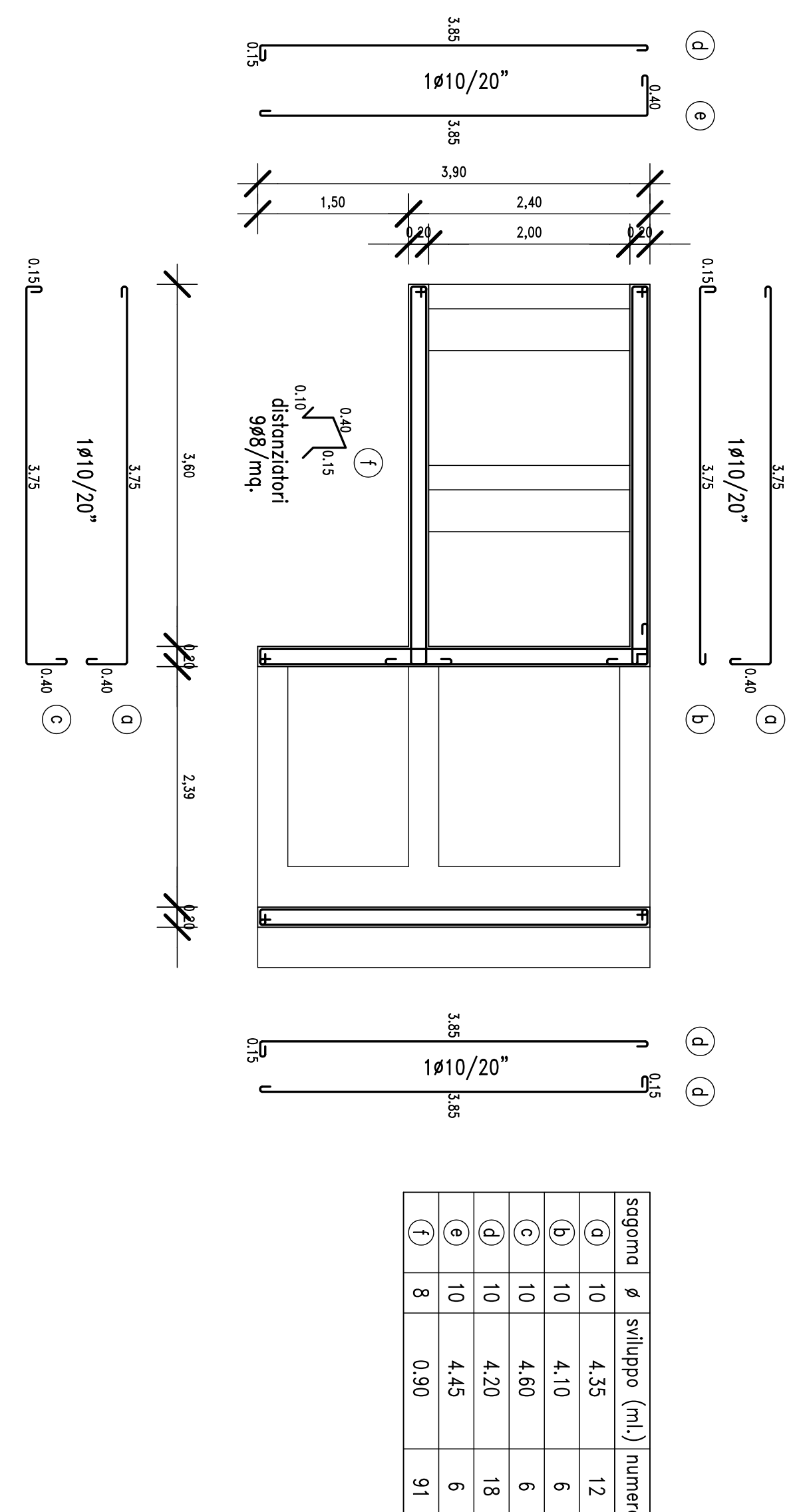

CARPENTERIA DA QUOTA +16,87
A QUOTA +19,02

ARMATURA ORIZZONTALE DA +17,68 A +19,02

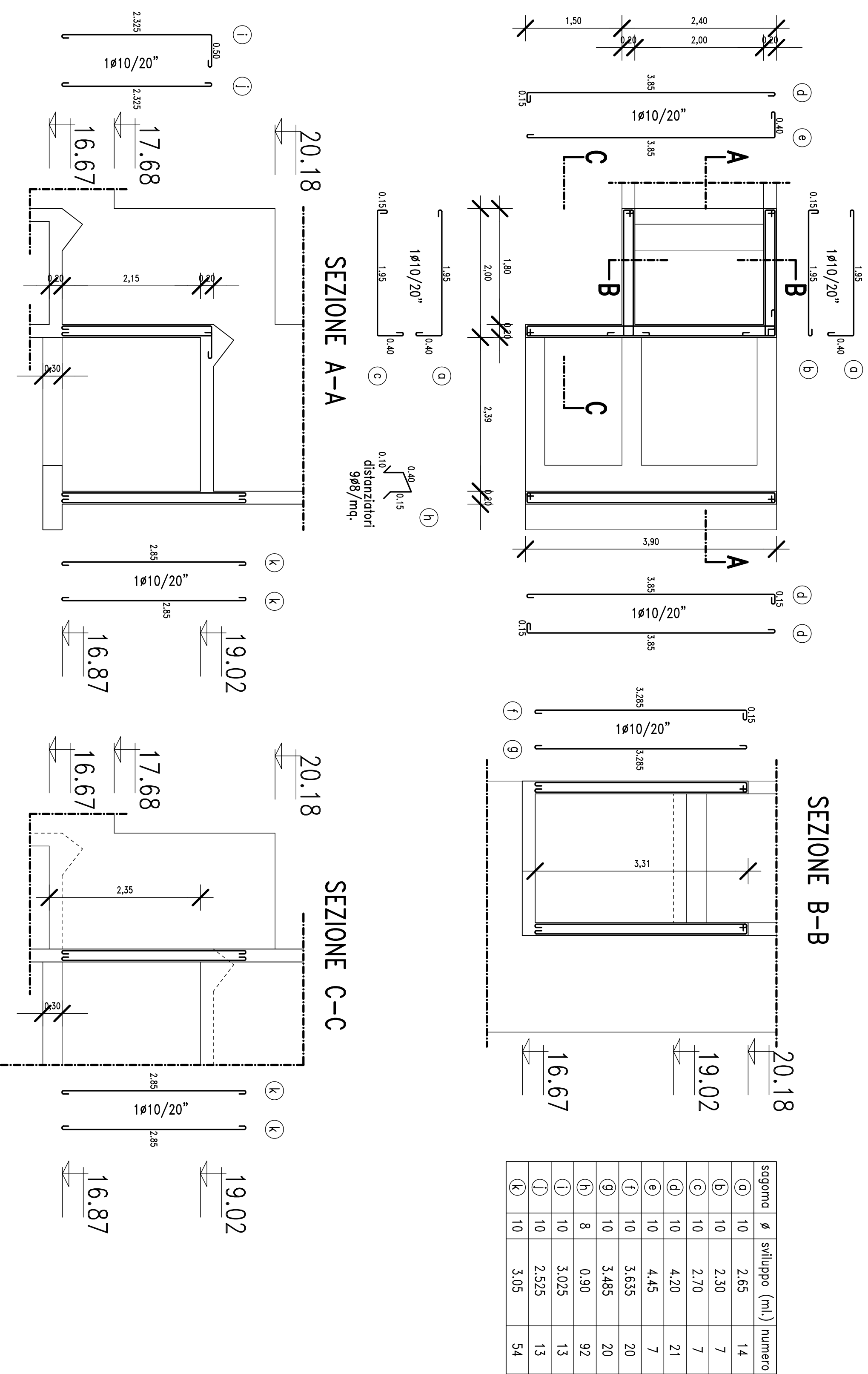

CARPENTERIA A QUOTA +19,02

PIANTA

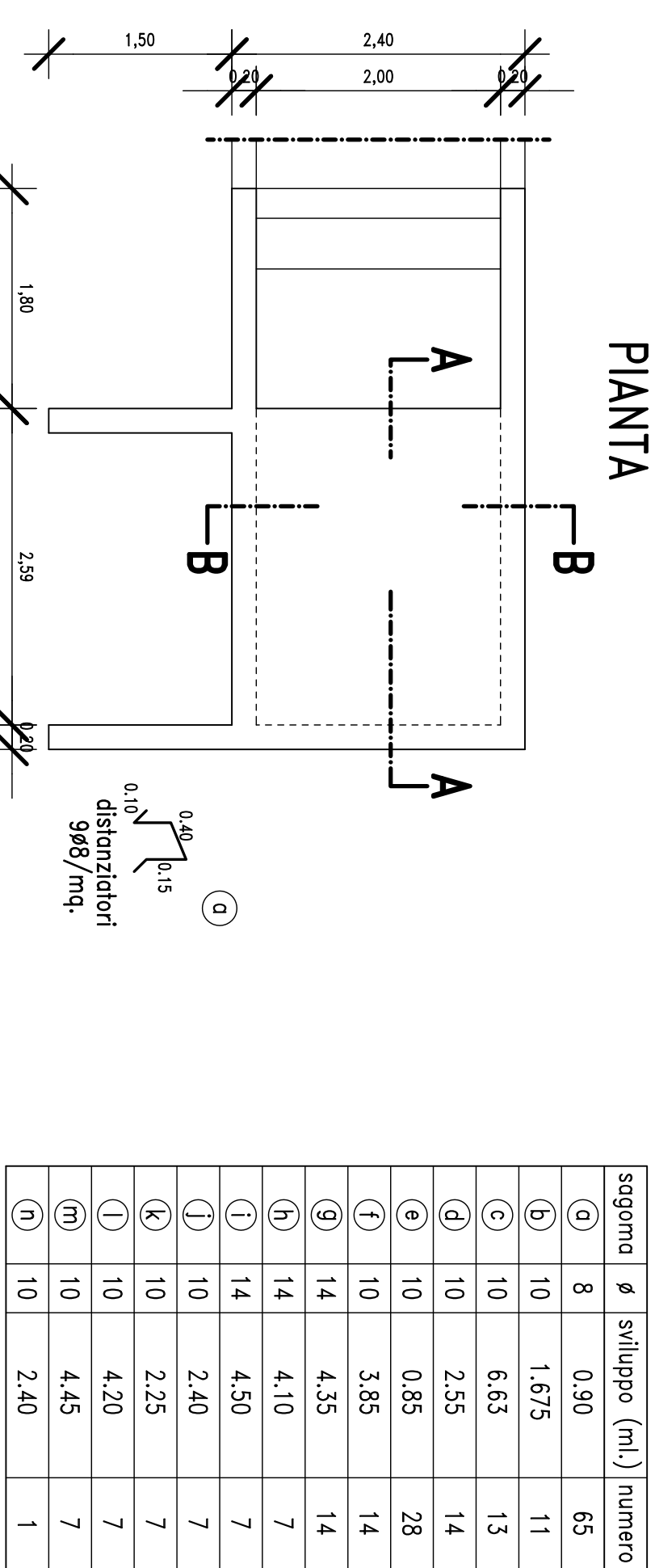

CARPENTERIA DA QUOTA +19,02
A QUOTA +20,18

ARMATURA ORIZZONTALE

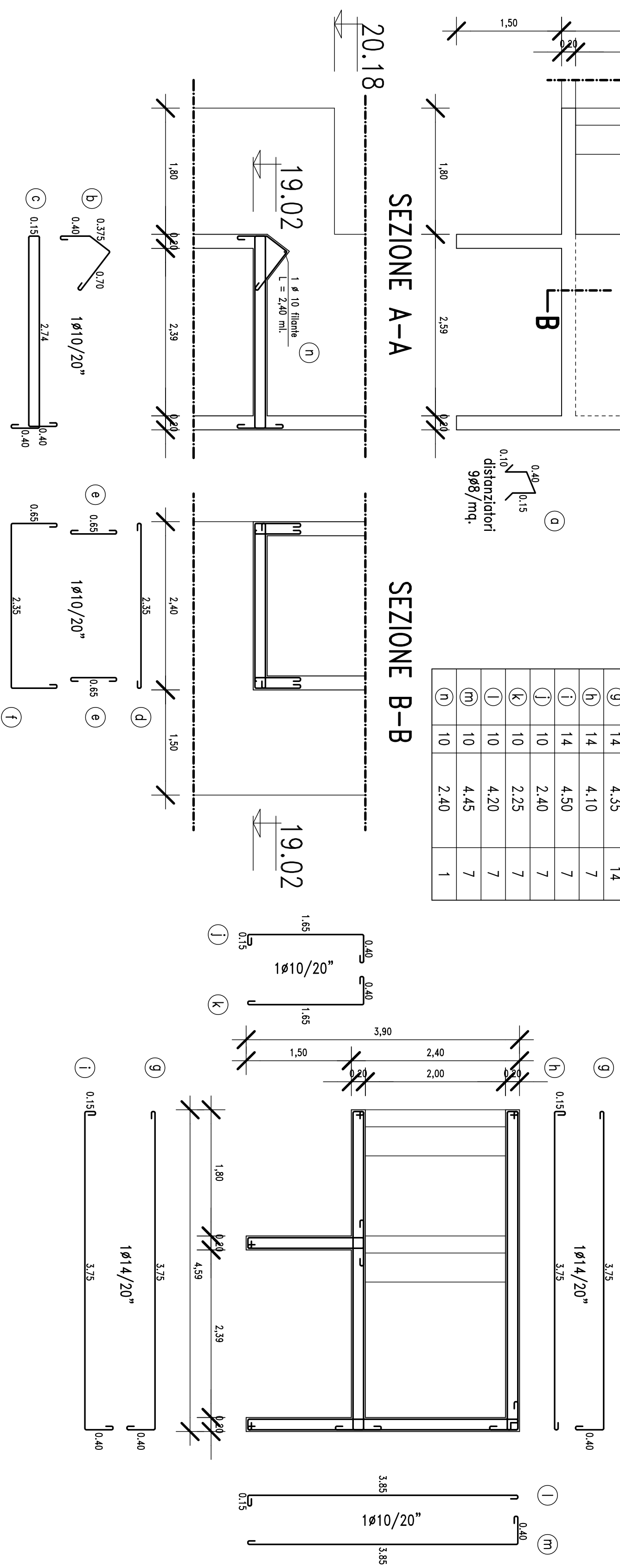

CARPENTERIA DA QUOTA +19,22
A QUOTA +22,68

PIANTA

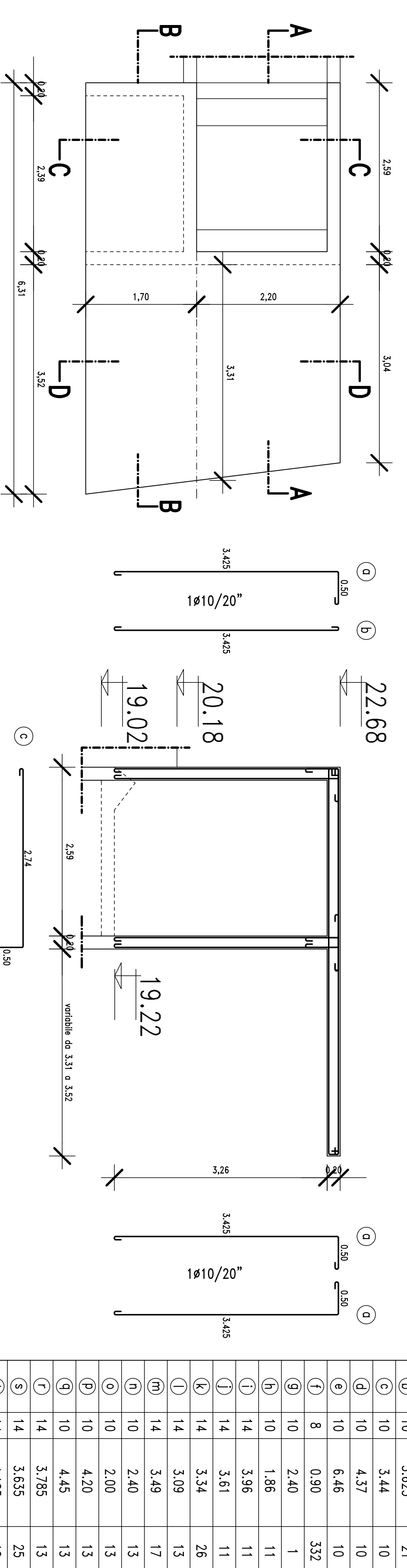

SEZIONE B-B

ARMATURA ORIZZONTALE DA +20,18 A +22,68

